

*Bold. Beautiful & Beyond*

DESIGNED TO CREATE AN UNFORGETTABLE, EMOTIONAL EXPERIENCE - A PERFECT HOME, TAILORED TO 21<sup>ST</sup> CENTURY LIFESTYLE. THE EPITOME OF LUXURY LIVING!

करतुरी  
ananta

4 BHK LUXURY HOMES

THE MOST SOPHISTICATED, HIGHLY AMENITIZED RESIDENCE THAT OFFERS A WORLD OF POSSIBILITIES TO ENVISION AND CRAFT A LIFESTYLE TO BE CELEBRATED NOW AND FOR GENERATIONS TO COME!



ABOUT US



Founded in 1990, **Meet Builders** is a front runner in building homes that surpass every standard. We're experienced, multi-disciplinary and a visionary organization committed to delighting our customers through innovative ideas in home design. This commitment has led us to build an impressive range of residences for every segment of the society. In all our projects, we strive to achieve the highest degree of technical excellence while maintaining the finest standards of business practices. No wonder, we keep winning prestigious industry awards and accolades year after year. This is just a beginning. We have bigger, better and bolder plans for the future of modern living. Welcome to **Meet Builders** and welcome to a new age lifestyle.



Bharat Patel  
(Founder)



Dhruv Patel  
(Co-founder)

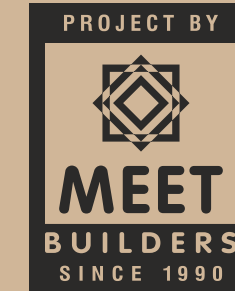

Meet Patel  
(Director)



Divy Patel  
(Director)

ARCHITECT'S VISION



Yash Gehi  
Architect, Interior & Landscape Designer  
India



Ishwar Gehi  
Architect, Interior & Landscape Designer  
India

To become an idol, one needs to design something ideal and surreal, which can be built in reality. Inspired by nature, we designed this project, that radiates style and energy like no other buildings in the city. More than the vivid elevations and glassy facades, the highlight of the project is the lush green courtyard centred amongst bold and beautiful towers.



ACTUAL  
SITE PHOTO

કસ્તુરી  
pride

Presenting Kasturi Pride located in the posh area of Panchvati Society in Rajkot. It is Gujarat's first of its kind high rise building with luxurious vertical gardens and car lifts. Such highlights of this project extraordinary has earned it a prestigious award of best residential project in ultra luxury segment.

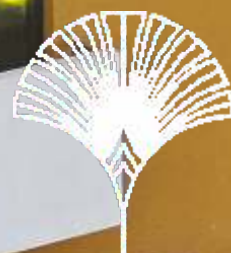

ACTUAL  
SITE PHOTO

कस्तुरी  
Casa

Man has forgotten his connection with nature with Kasturi Casa, it is our endeavour to bring man and environment together again.

TO A NEW

*Beginning*

It's not just a building but an entire lifestyle waiting to welcome you to your new home. A little piece of heaven, just for you.

कस्तुरी  
Sananta



ICONIC  
Design



कर्तुरी  
ananta



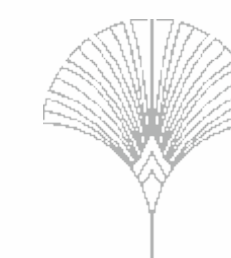

SUMPTUOUSLY

*Inviting*

There's nothing as powerful and alluring as a refreshing first impression. Arrive in style to your private world, where luxury, exclusivity and tranquility collaborate seamlessly.





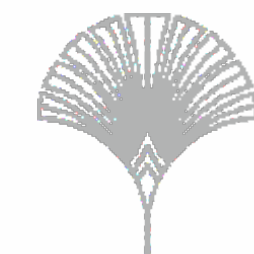

UNRIVALLED

*Craftsmanship*

Created with passion, imagination and attention to every detail, these exceptional homes are individual masterpieces.



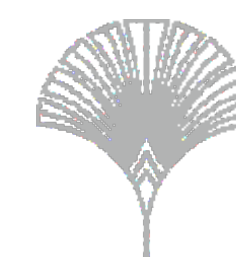

CONTEMPORARY

*Character*

Enjoy contemporary architecture and bespoke amenities that enhance your lifestyle - allowing you to relax the body, free the mind and enjoy the perks of luxury living.

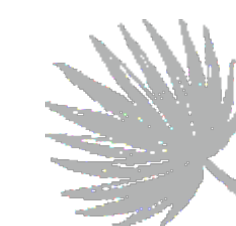



TIMELESSLY

*Elegant*

Every detail has been carefully selected to fit into a harmonious vision that feels elegant and classic. From jaw-dropping window compositions to landscaped courtyard, it's clear that **Kasturi Ananta** is a work of art.

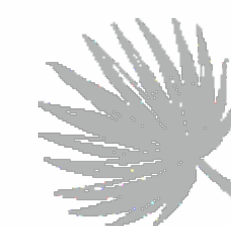

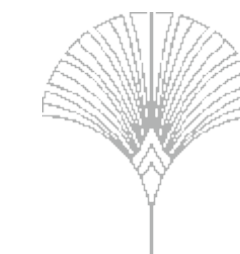

**DISTINCTIVE**  
*Details (Lifts)*

Combining function, quality and style, it's the details that really set these homes apart. Besides open concept layouts, all the residences feature a private elevator with a private lobby. Additional stretcher lift and service lift is also provided for the ultimate convenience.





ELEVATED  
*Lifestyle*

Social courtyards invite residents and their guest outside to relax, refresh and socialise in the ultimate urban oasis.





PARTY HALL



THEATRE



INDOOR GAME ZONE



GYMNASIUM

# BASEMENT

Plan

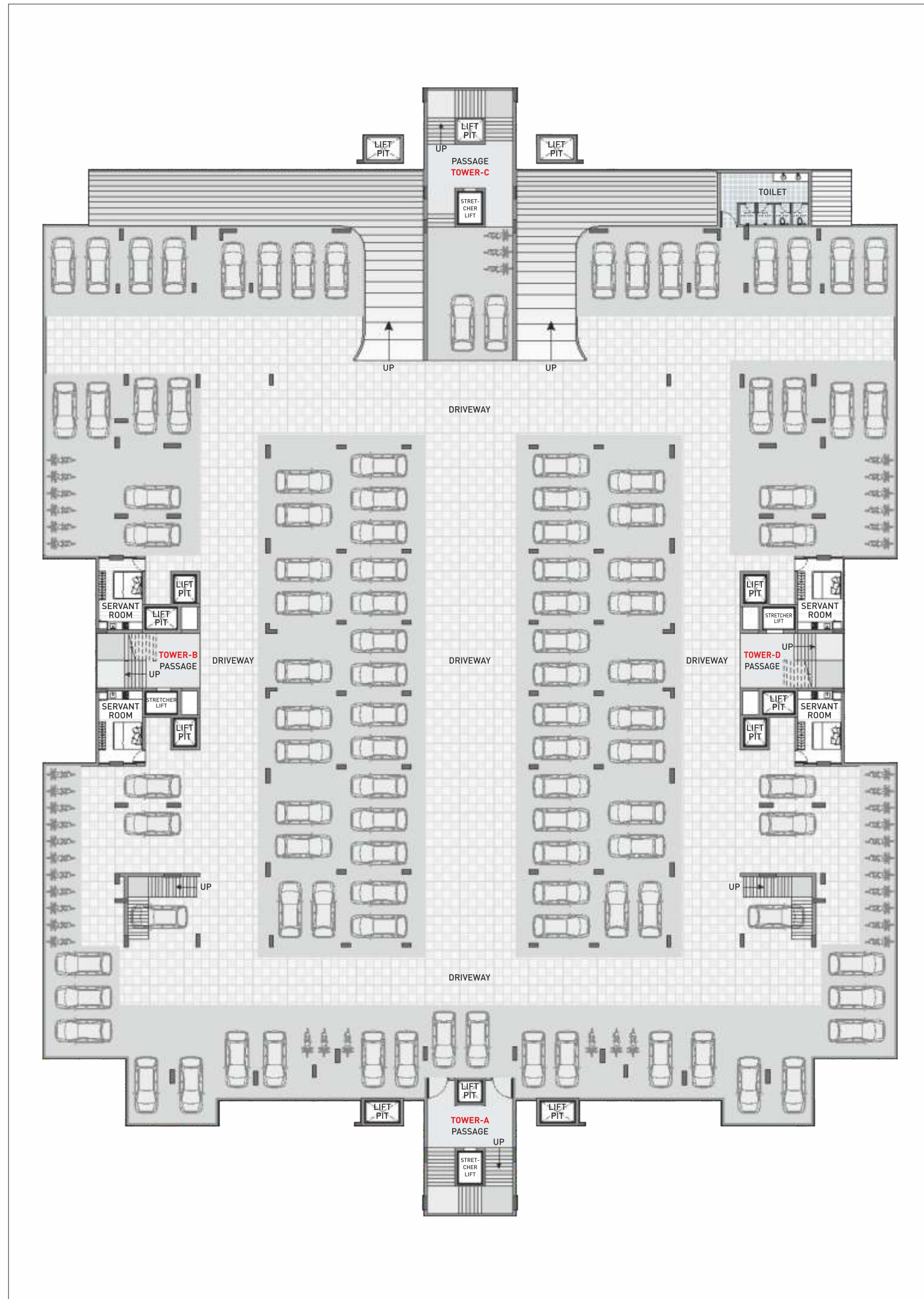

18.00 MT. TP ROAD

# GROUND

Floor Plan

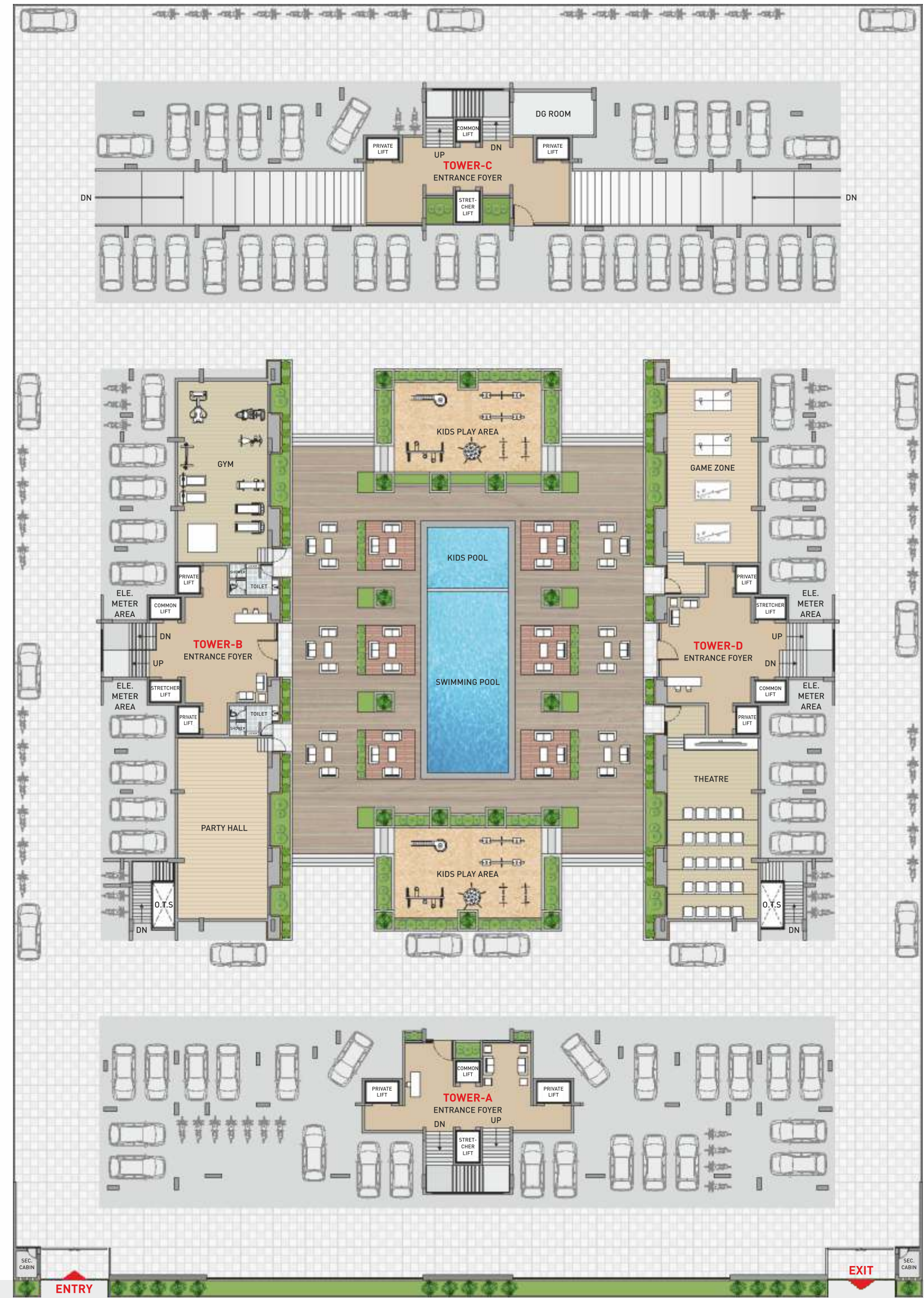

18.00 MT. TP ROAD

**SALIENT FEATURES**



**PARKING**

Double heighted basement & ground level parking.  
2 cars per flat with a provision of 3<sup>rd</sup> car.



**LIFTS**

4 lifts per tower, including 2 high speed owner's lifts,  
1 high speed guest lift & 1 stretcher lift.



**KITCHEN**

Platform of composite marble or  
high-end granite with SS / Acrylic sink.



**BATHROOM**

Kohler / Hansgrohe or such international brands concealed  
bath fittings including body jets and rain shower.  
Sanitaryware of Kohler / Toto or such international  
brands table tops and wall hung commodes.



**WINDOWS**

Window sill - high quality Granite / Kota sill frame on all 4 sides.  
All windows to be provided with aluminium section / UPVC with  
a provision of mosquito net.



**COLOR**

Putty finish on interior walls.  
100% weather resistant acrylic paint / texture on external walls.



**PICTURE PERFECT COURTYARD**

Distance between towers - 191 ft. from A to C & 90 ft. from B to D.  
17,000 Sq. Ft. of Landscaped Courtyard.



10'3"  
103" FLOOR  
HEIGHT



**FLOORING**

Stylish large sized vitrified tiles.



**DOOR**

Designer main door with digital lock.



**ELECTRIC**

In all areas 3 phase concealed ISI copper wiring,  
modular switches & MCB distribution panel.



**PLUMBING**

Plumbing fittings to be provided of standard  
ISI brands such as Supreme, Astral or Ashirwad.

**TYPICAL**

Floor Plan

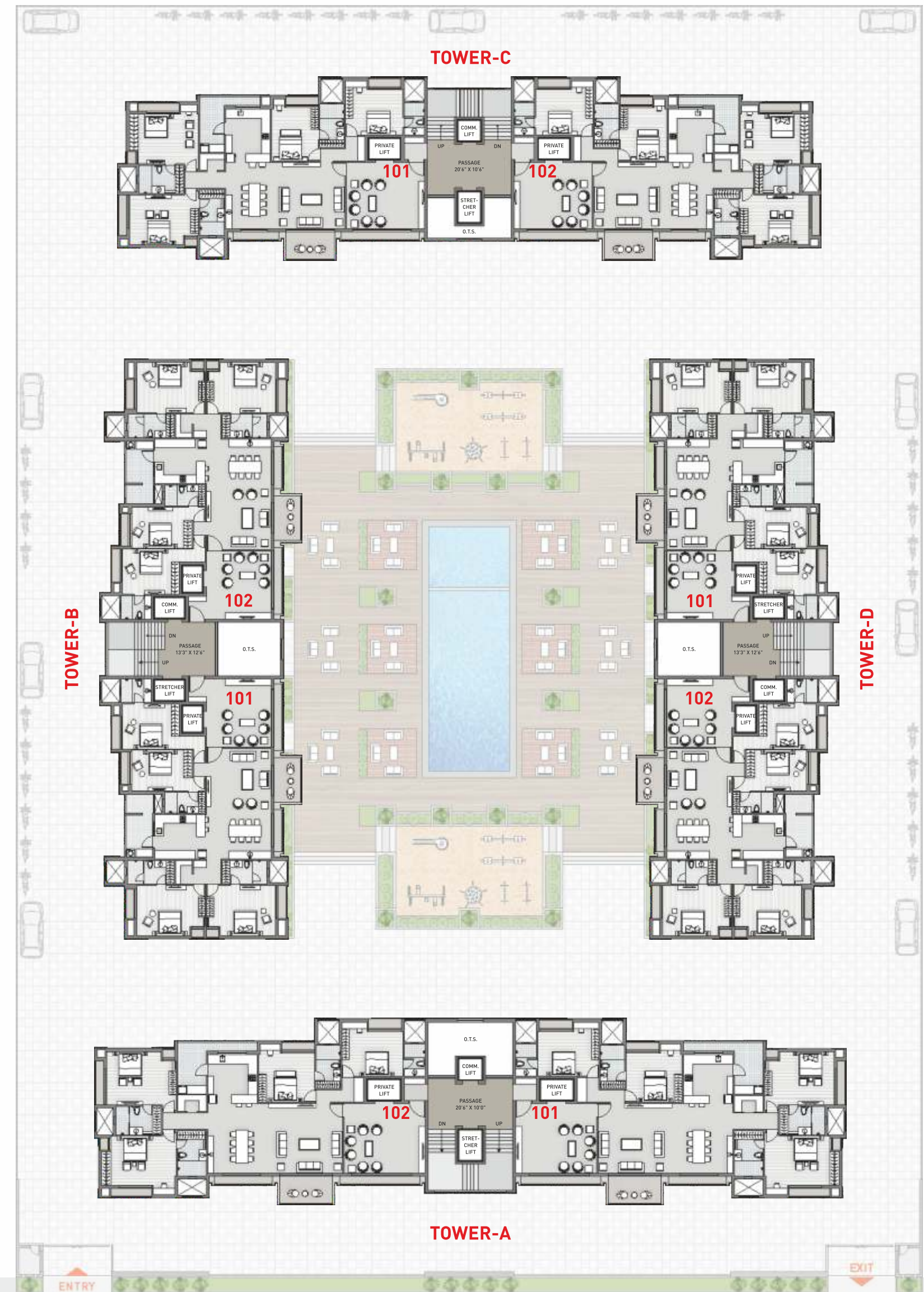

18.00 MT. TP ROAD



Typical Floor Plan



Typical Floor Plan



Typical Floor Plan



Typical Floor Plan





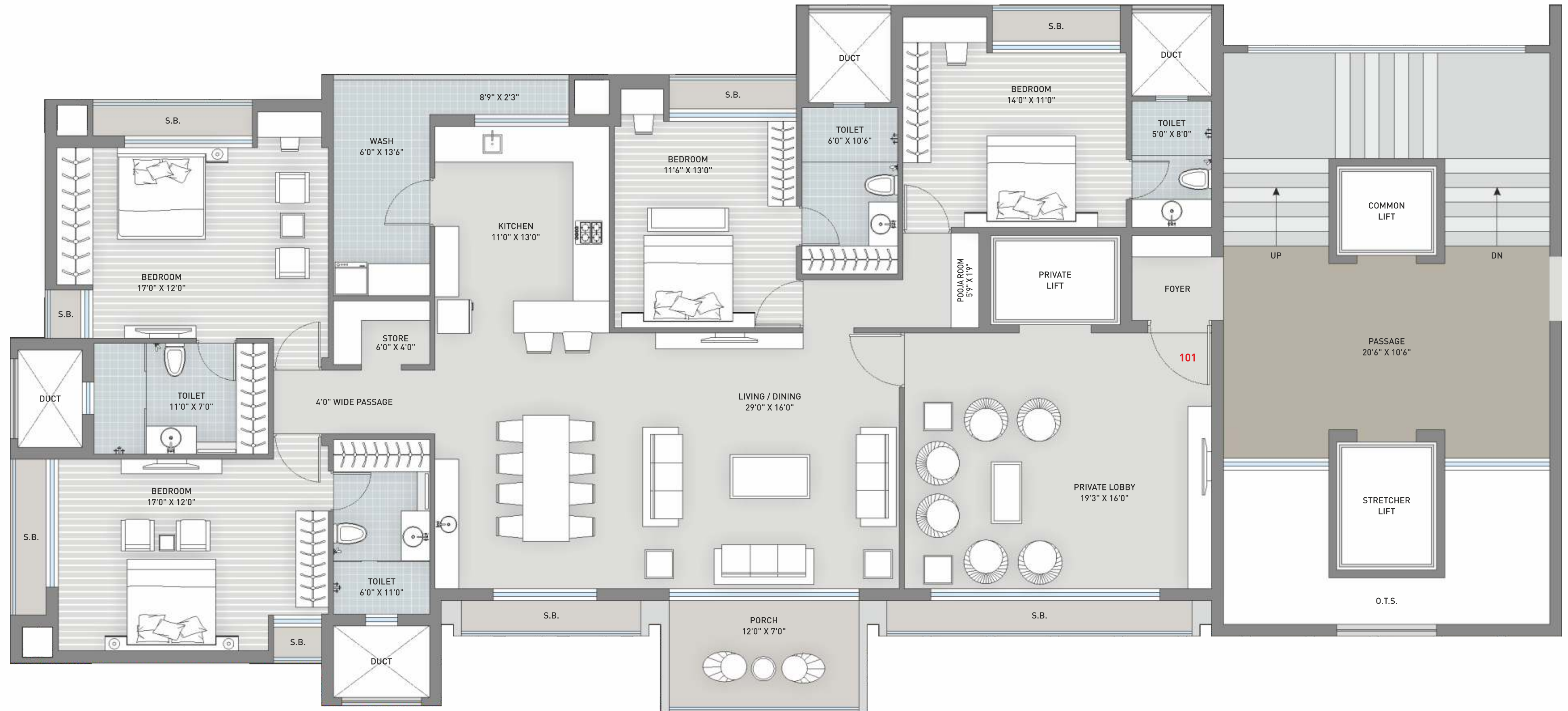

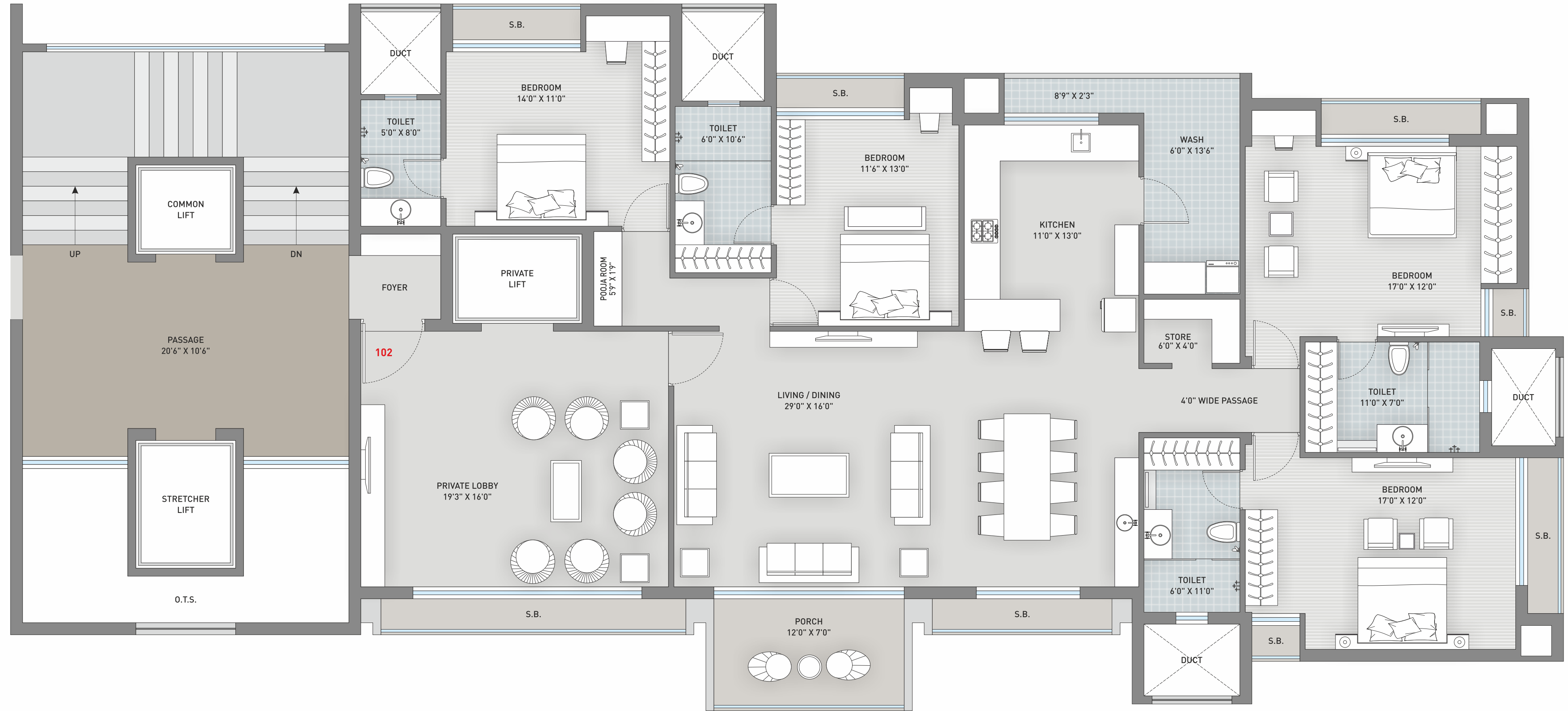







Typical Floor Plan





## GENERAL AMENITIES & FEATURES

 Kid's Play Area	 Grand Entrance	 Electric Meter Area	 Center Garden
 Decorative Lighting	 Sr. Citizen Garden	 CCTV Camera	 Swimming Pool
 24 X 7 Security	 Fire Fighting System	 Generator	 Sr. Citizen Sit Out

**कर्तुरी**  
ananta

Kalawad Road, Mota Mauva,  
Opp. Celebration Party Plot, Nr. Grace College, Rajkot.

Contact  
98207 85815  
99097 00300

SCAN FOR  
LOCATION



Architect, Interior &  
Landscape Designer

ISHWAR GEHI ARCHITECTS

YASH GEHI  
ISHWAR GEHI  
INDIA

Developer



Prasang Hall, Besides Giriraj Hospital,  
150 Ft. Ring Road, Rajkot.  
<http://meetbuilders.com/m/>

Structural Engineer

DILIP LADANI

## KEY PLAN

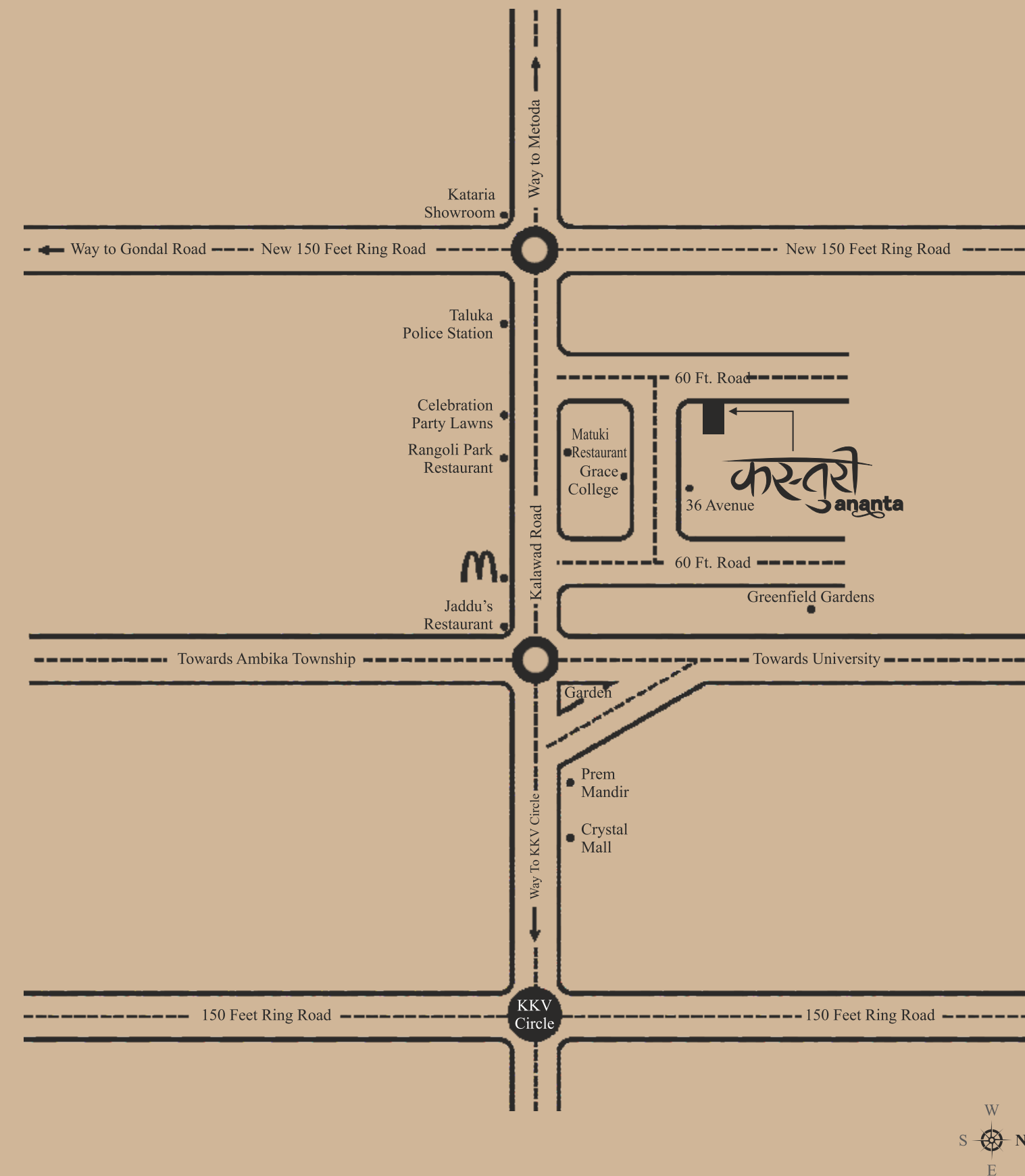

RERA Reg. No. : PR/GJ/RAJKOT/RAJKOT/Rajkot Municipal Corporation/RN91AA09991/230622  
Website : [www.gujrera.gujarat.gov.in](http://www.gujrera.gujarat.gov.in)

LEGAL DISCLAIMER: All the elements, objects, treatment, materials, equipment & colour scheme shown in the brochure are artisan's impression & purely for presentation purpose. By no means it will form a part of the amenities, features or final product.

NOTE: All rights for alteration, modification & development in design or specifications on by architects & / developer shall be binding to all the members. Completion certificates as per RMC rules, clear title document will be provided by promoters for loan purpose. This brochure is for private circulation only. By no means it will form a part of any legal contract.

Stamp duty registration charges, legal charges, PGVCL charges, society maintenance deposit etc. shall be borne by the purchaser. • TDS, TCS, GST & / any other taxes levied in future will be borne by the purchaser as applicable. • Any additional charges or duties levied by the government / local authorities during or after completion of the scheme shall be borne by the purchaser. • In the interest of continual developments in design & quality of construction, the developer reserves all rights to make any changes in the scheme including and not limited to technical specifications, design, planning, layout & all purchasers shall abide by such changes. • Changes / Alteration of any nature including elevation, exterior colour scheme, balcony grill or any other changes affecting the overall design concept & outlook of the scheme are strictly NOT PERMITTED during or after the completion of the scheme. • Any RCC member (beam, column, slab) must not be damaged during your interior work. • Low - voltage cables such as telephone, TV and internet cables shall be strictly laid as per consultant's service. • No wire / cables / conduits units shall be laid or installed such that they form hanging formation on the building exterior faces. • Common passages / landscaped areas are not allowed to be used for personal purpose. • AC outdoor units space is already designated in consultation with HVAC consultant. It is planned according to design specification / elevation, available space etc. • No changes in location can be made on personal basis.